



AMCO

Estd 1986

AMCO INDUSTRIAL VALVES

● MANUFACTURERS ● EXPORTERS

KNIFE EDGE GATE VALVE

PRODUCT DATA SHEET

AIV-K01-M
UNI

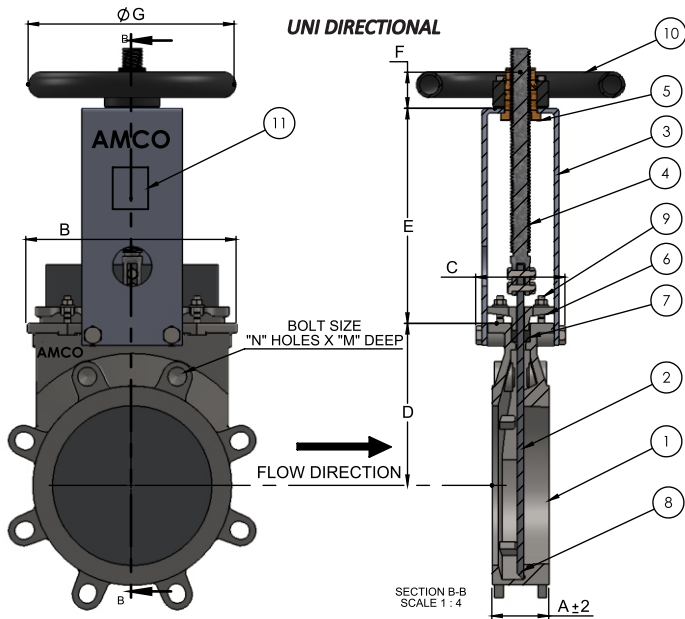

DIMENSIONS

Size	A	B	C	D	E	F	ϕG	Wt. (Kg.)
2"/50	48	120	100	105	129	47	225	8
3"/80	51	150	100	126	162	47	225	10
4"/100	51	171	100	140	187	47	225	12
5"/125	57	180	100	160	211	47	225	16
6"/150	57	210	100	175	237	47	225	20
8"/200	70	266	122	205	309	67	310	32.5
10"/250	70	318	122	250	364	67	310	47
12"/300	76	376	122	300	414	67	310	65

Approx.

BILL OF MATERIAL

Part	Specification		
	WCB	CF8	CF8M
1. Body	ASTM A216 Gr. WCB	ASTM A351 Gr. CF8	ASTM A351 Gr. CF8M
2. Gate	Stainless Steel SS304	Stainless Steel SS304	Stainless Steel SS316
3. Yoke	Carbon Steel	Carbon Steel	Carbon Steel
4. Spindle	Stainless Steel SS304	Stainless Steel SS304	Stainless Steel SS316
5. Stem Bush	SGI Iron	SGI Iron	SGI Iron
6. Gland	ASTM A216 Gr. WCB	ASTM A351 Gr. CF8	ASTM A351 Gr. CF8M
7. Gland Packing	EPDM + GR. Rope	PTFE Impregnated	PTFE Impregnated
8. Seat	SS304	SS304	SS316
9. Fasteners	High Tensile	Stainless Steel	Stainless Steel
10. Hand Wheel	Ductile Iron	Ductile Iron	Ductile Iron
11. Name Plate	Stainless Steel	Stainless Steel	Stainless Steel

BOLTING DETAILS

Size	BSW	Metric	N x M
2"/50	5/8"	M16	2 X 12mm
3"/80	5/8"	M16	2 X 12mm
4"/100	5/8"	M16	2 X 14mm
5"/125	3/4"	M20	2 X 14mm
6"/150	3/4"	M20	2 X 14mm
8"/200	3/4"	M20	2 X 14mm
10"/250	7/8"	M22	4 X 15mm
12"/300	7/8"	M22	4 X 15mm

Technical Specification

Design Standard	MSS-SP-81
Testing Standard	MSS-SP-81
Seat Test	10 Kg/Cm2
Direction	Uni Directional
End Connection	ANSI B16.5 150# Others on Request

Seat Types

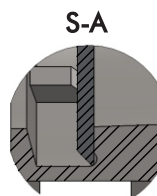

METAL / METAL (S-A)

For applications with:

- High temperature, above 250° C
- High density media application
- When full tightness is not required
- Class IV Leakage

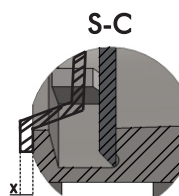

DEFLECTION CONE (S-C)

- Deflects the media away from any internal exposed parts of the valve such as gate guides, seat, etc.
- Different types of material available such as AISI 316 stainless, CA15, Ni-Hard, etc.

Face to face dimensions increase:
DN50 to DN 250 X = 9mm
DN300 to DN 600 X = 12mm
Larger diameters on request.

Operation

Hand Wheel Pneumatic Cylinder* Gear Operated*

* On Request

** Special Material And Requirement Available On Request

*** We Reserve The Right To Change Design And Technical Data Without Any Prior Notice.